

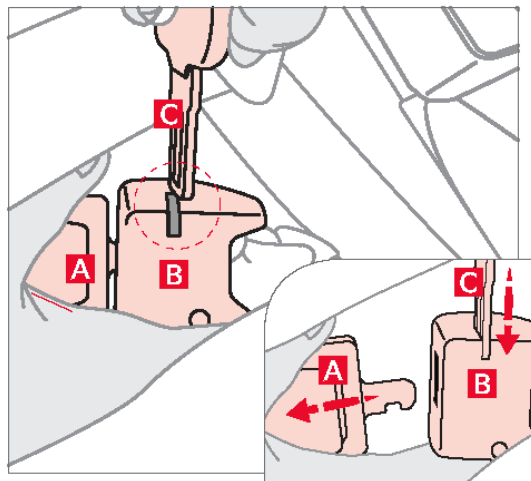

TO: Dealer Sales & Service Team
SUBJECT: IQS Quick Tip #20 – Center Shoulder Seat Belt Operation
DATE: February 2023

During the customer-focused delivery process on the 2023 MY Carnival and Telluride, a thorough demonstration of the fastening and unfastening of the 3rd row center seat belts, including proper stowage should be conducted. The customer should also be made aware that the lap belt tongue plate can be used to retract the seat belt webbing from the center anchor/buckle without the need for tools.

Unfastening the Center Shoulder Seat Belt from Buckle



- 1 If Seat Belt is buckled, press the release button on the buckle.
- 2 To retract the center seatbelt webbing **A** in 2nd and/or 3rd rows, use the lap belt tongue plate **C** to push “release button” in the small slot on the center belt buckle **B**.

UD210-KU-005

When not in use the seat belt can be retracted and stowed back into the headliner. This may help to prevent potential customer IQS Difficult to Use (DTU) complaints.

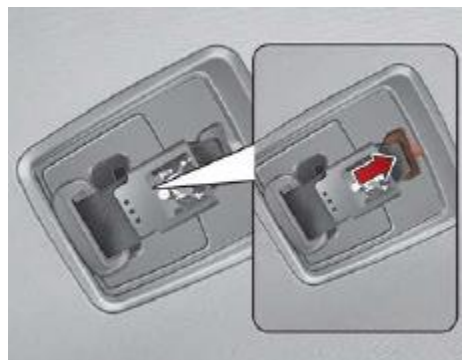

Unfastening Center Seat Belt Video:

https://www.youtube.com/embed/fk7JKED_Oeo



Sincerely,

Ownership Experience Team
Kia America

For additional resources and other information related to potentially difficult to understand features, visit the IQS learning center within the Product Presentation Center.

<https://kiappc.com/kia-learning-center/kia-quality-center/tips-resources/>